

TUBE & CARE

TUBE TOOLS

TUBE CLEANING TOOLS

TUBE EXPANDERS - ROLLING CONTROLS - INSTALLATION - REMOVAL - CLEANERS



sales@tubeandcare.com



www.tubeandcare.com

TUBE & CARE

Tube & Care was founded in 2016 by Group of Experts after having 10 years excellent work experiences in same field. After the initial years of struggle, thorough hard work, foresight and persistence the company involved from 4 person to dynamic 25 plus person workforce distributed over 2 manufacturing facilities and 8 sales and services office in major cities of India. Now focusing on global market to serve same products with best quality, price and delivery.

QUALITY - PRICE - DELIVERY

- Quality - We have realized that to survive and grow in todays international market we must produce products equal to or better than the best available in the world, else we should cease from producing them. We also must provide our customers with added values to help us grow and increase our market share worldwide.
- Price - We will not attempt to sell a product worldwide if we are not able to offer our customers significant price savings. We will use our strengths of having a competitive labour force to decide on new products lines.
- Delivery - We will use our price advantage to increase our inventory levels to an extent that higher cost manufacturers would find difficult to match. We will attempt to ship out orders the same day via UPS, FED EX or DHL to our customers worldwide so it reaches them within days of the order. Automated inventory control, on-line ordering systems and our Same Day Shipment program ensure efficient order placement and execution cycles.

TUBE & CARE

Trademark of **TUBE AND CARE ENGINEERS**

REGISTERED OFFICE

**SHOP NO. 04, BLDG NO. 02, MOHAN GREENWOODS, MHATRE ROAD,
MANJARLI, BADLAPUR (W), THANE – 421503, INDIA**

Tel. : +91 9987977574 / 0251 271 1621

Email : tubeandcare@gmail.com / sales@tubeandcare.com / tubeandcare@gmail.com

After Sales and Service Centers

MAHARASHTRA
MUMBAI
PUNE

RAJASTHAN
KOTA
UDAIPUR

DELHI

GUJRAT
AHMEDABAD
SURAT

TAMIL NADU
CHENNAI

WEST BENGAL
KOLKATA

MANUFACTURING FACILITIES

**C-204, UDYOG VIHAR INDUSTRIAL COMPOUND
ULHASNAGAR, MUMBAI 421**

CONDENSER TUBE CLEANING- ELECTRIC & PNEUMATIC

ELECTRIC TUBE CLEANER



Features :

Tube & Care Electric tube cleaner are environment friendly compact and easily mensurable unit. In heat exchanger, condensers, boilers and other tube apparels They work by attaching a cleaning tool (to be determined on type of deposit to be cleaned) to a flexible shaft. The Electric Tube Cleaner provides rotary motion to the flexible shaft which rotates the cleaning tool inside the tube. If needed water passes through the flexible shaft to aid in flushing out of the deposits.

All Electric Tube Cleaners are supplied with forward direction foot switch.

- Water flushes through the shaft and helps remove deposits from tube.
- Flexible shaft can be easily disconnected.
- Stainless steel body for use in harshest environment.
- Forward direction foot switch enable operation to concentrate or cleaning operation without worrying about cleaner.
- Easy interchangeability of various shafts and accessories for maximum versatility.
- Large wheels for easy transportation. Water consumption can be regulated as needed.

TUBE ID		MODEL	MOTOR POWER		SPEED	WEIGHT		DIMENSION		
MM	INCH		HP	KW		Lbs	Kg	HEIGHT	WIDTH	DEPTH
6.4-25.4	1/4-1	PTC-60	0.75	0.60	910	66	30	38"(975MM)	21"(535MM)	18"(457mm)
25.4 & UP	1 & UP	PTC-75	1.00	0.75	910	70	32	38"(975MM)	21"(535MM)	18"(457mm)
25.4 & UP	1 & UP	PTC-150	2.00	1.50	910	84	38	40"(1015MM)	22"(560MM)	19"(487mm)

PORTO ELECTRIC TUBE CLEANER



Features :

Tube & care PORTO is built for users to whom a small size and easy transportation means they can clean more tubes. Used to clean 1/4" - 1" ID tubes in chillers, evaporators, and heat exchanger. The flexible shaft rotates at 1760 rpm as water feeds through the nylon casing to the cleaning tool. As the tool removes the deposits, the water flow flushes them out. A solenoid valves ensures that water flows only when the machine is running. Water consumption can be regulated as needed.

- Compact and portable for use in multiple locations.
- Easy connect and disconnect of various shafts and cleaning tools
- Foot switch enables operator to concentrate on cleaning operation.
- Water moving through shaft flushes out deposits already dislodged by cleaning tools.

TUBE ID		MODEL	MOTOR POWER		SPEED	WEIGHT		DIMENSION		
MM	INCH		HP	KW		Lbs	Kg	HEIGHT	WIDTH	DEPTH
6.4-25.4	1/4-1	PORTO	0.50	0.40	1760	36	16	10"(254MM)	11"(279MM)	18"(457mm)

PNEUMATIC TUBE CLEANER



Features :

"Tube & Care" Model ATC-300, Extra Heavy Duty Pneumatic Tube Cleaning Machine includes air filter, regulator, lubricator, adjustable speed / torque control, mobile dolly, tool storage box and air foot pedal. The ATC-300 uses a cleaning tool mounted to the tip of a flexible shaft, which is available in different lengths and diameters to fit the size of the tube to be cleaned. For wet applications, as the shaft rotates inside its watertight nylon casing, the unit feeds water through the casing to the cleaning tool. A foot pedal controls shaft rotation and water flow. While the operator feeds the rotating shaft assembly through the tube, the water flushes out deposits as they are loosened.

- Shock Resistant - Excellent for applications where using electric equipment is hazardous.
- Corrosion Resistant - Stainless steel cover and chassis for long life.
- Versatile - Interchangeability of different size flexible shafts and cleaning tools.
- Speed / Torque Control - Shaft rotation can be set at optimum speed at each application.
- No Tooling - Quick disconnect of flexible shaft.
- Easy Maneuverability - Large Wheels.
- Time Saving - Simultaneous water flush to remove deposits from tubes.

TUBE ID		MODEL	MOTOR POWER		SPEED	WEIGHT		DIMENSION		
MM	INCH		HP	KW		Lbs	Kg	HEIGHT	WIDTH	DEPTH
6.4-UP	1/4 & UP	ATC-300	4	3.00	300-3000	64	29	38"(975MM)	22"(560MM)	16"(406mm)

PNEUMATIC ATC-100 TUBE CLEANER



Features :

"Tube & Care" Model ATC-100, Portable Duty Pneumatic Tube Cleaning Machine includes FRL, adjustable speed / torque control and air foot pedal. The ATC-100 uses a cleaning tool mounted to the tip of a flexible shaft, which is available in different lengths and diameters to fit the size of the tube to be cleaned. For wet applications, as the shaft rotates inside its watertight nylon casing, the unit feeds water through the casing to the cleaning tool. A foot switch controls shaft rotation and water flow. While the operator feeds the rotating shaft assembly through the tube, the water flow softens the deposits before cleaning and flushes them out during cleaning.

- Shock Resistant - Excellent for applications where using electric equipment is hazardous.
- Versatile - Interchangeability of different size flexible shafts and cleaning tools.
- Speed / Torque Control - Shaft rotation can be set at optimum speed at each application.
- No Tooling - Quick disconnect of flexible shaft. Time Saving - Simultaneous water flush to remove deposits from tubes.
- Compact - Light weight easy to operate inside drum.
- Cleanliness - Foot pedal for operator convenience to activate shaft rotation and water flow to reduced water consumption and cleaner working area.

TUBE ID		MODEL	MOTOR POWER		SPEED	AIR SUPPLY		WEIGHT		DIMENSION		
MM	INCH		HP	KW		MIN	MAX	Lbs	Kg	HEIGHT	WIDTH	DEPTH
6.4 & UP	1/4 & UP	ATC-100	0.50	0.40	300-3000	60psi @ 1.5cfm	100psi @ 70cfm	26	12	10.3/8"(254MM)	6"(152MM)	19"(483mm)

CONDENSER TUBE CLEANING ACCESSORIES

FLEXIBLE SHAFT

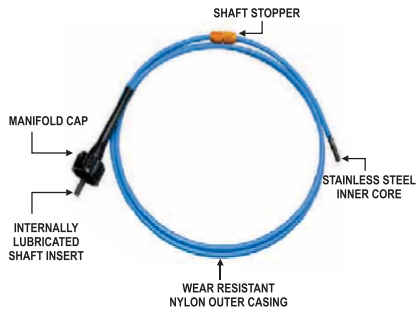

Features :

FLEXIBLE SHAFTS WITH STAINLESS STEEL INNER CORE For PTC-40, PTC-60, PTC-75, PTC-150, ATC-300

When ordering flexible shafts and accessories, each item should be ordered for specific tube / pipe size or size range. Shafts have color coded shaft stops for easy identification. Stainless steel inner core ensures our shafts have longest life, flexibility and resistance to corrosion. Since the inner core of the shafts are heart of the system and take most of the strain, stainless steel inner cores cause our shafts to last longer than the competition.

To order flexible shaft(s), determine tube ID(s) and length of the longest tubes(s). Order flexible shaft(s) to correspond with tube ID(s) and length. Please ask for special or longer lengths.

TUBE ID		MODEL	FLEXIBLE SHAFT LENGTH		SHAFT CORE O.D.		SHAFT CASING O.D.		TOOL END THREAD
MM	INCH		FEET	MTRS.	MM	INCH	MM	INCH	
6.4-9.5	1/4-3/8	PFS-250-40	13	4.0	3.2	1/8	6.4	1/4	8 - 32 F
		PFS-250-79	26	7.9					
11.1-12.7	7/16-1/2	PFS-375-40	13	4.0	6.4	1/4	9.5	3/8	1/4 - 28 F
		PFS-375-55	18	5.5					
		PFS-375-79	26	7.9					
		PFS-375-110	36	11.0					
		PFS-375-140	46	14.0					
14.3-25.4	9/16-1	PFS-500-40	13	4.0	7.9	5/16	12.7	1/2	1/4 - 28 F
		PFS-500-55	18	5.5					
		PFS-500-79	26	7.9					
		PFS-500-110	36	11.0					
		PFS-500-140	46	14.0					
		PFS-500-184	61	18.4					
17.5-25.4	1 1/16-1	PFS-560-40	13	4.0	9.5	3/8	14.3	9/16	1/4 - 28 F
		PFS-560-55	18	5.5					
		PFS-560-79	26	7.9					
		PFS-560-110	36	11.0					
		PFS-560-140	46	14.0					
		PFS-560-184	61	18.4					
		PFS-560-232	76	23.2					

FLEXIBLE SHAFT REPAIR AND MAINTENANCE

For PFS-250, PFS-375, PFS-500, PFS-560 and PFS-750 Flexible Shaft

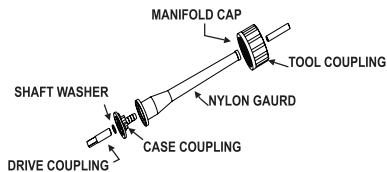

REPAIR TOOL



SHAFT REPAIR TOOL - Allows user to quickly and safely attach couplings onto the shaft ensuring maximum useful life for the shaft. SHT-1, Shaft Repair Tool with Hammer SHP-1, Replacement Hammer

LUBRICANT



Flexible Shaft Lubricator - Used to lubricate flexible shaft for maximum useful life. They are used to lubricate shafts prior to storage. The lubricator is filled with a water soluble lubricant that enters and lubricates the shaft when air supply is provided to the lubricator. The residue lubricant washes out with water when the shaft is used again.

LUBRICATOR



PFLS-1, Flexible Shaft Lubricator
PLUBE - Lubricant for flexible shaft lubricator,
8 ounce (0.25 litres).

CONDENSER TUBE CLEANING BRUSHES



NYLON BRUSHES - Used for removing soft scales in the ferrous (carbon & stainless steel) and non-ferrous (copper, brass, plastic etc) tubes and for final finishing of tubes.

STAINLESS STEEL BRUSHES - Used for removing soft and light scale deposits in the ferrous (carbon & stainless steel) tubes.

BRASS BRUSHES - Used for removing soft and light scales deposits in straight, non-ferrous (copper, brass, nickel and their alloyed) tubes.

BRUSH O.D.

	MM	INCH
FROM	6.4	1/4
UPTO	25.4	1

CUTTER HEADS & BUFFING TOOLS



Carbide Drills - Used for cleaning tubes choked solidly with hard deposits.

TUBE I.D.

	MM	INCH		MM	INCH
FROM	6.4	1/4	UPTO	17.5	11/16

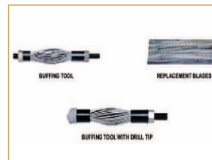

BUFFING TOOLS - Used for final polishing or removal of light and soft deposits from ferrous and non-ferrous tubes that have been previously cleaned. Used in straight or very large radius tubes in a clockwise direction only.

TUBE I.D.

	MM	INCH		MM	INCH
FROM	7.9-9.5	5/16-3/8	UPTO	15.9-25.4	5/8-1

CONDENSER PNEUMATIC TUBE CLEANER

PORTABLE PNEUMATIC TUBE CLEANER C-10

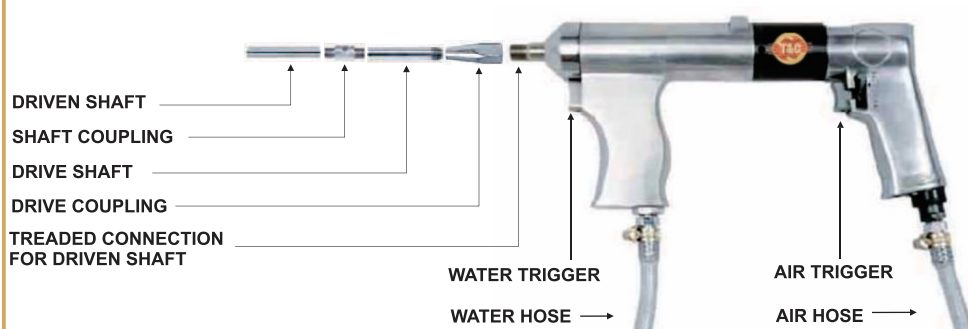

C-10 GUN KIT



Build your own kit by adding of drive as per your length of your tube to clean.. (C-10 or CP-315)
Hollow Drive & Driven Shafts, Shaft & Drive Couplings based on length of tube to be cleaning tools.

The portable pneumatic tube cleaner use hollow shafting of different diameters as per tube ID to be cleaned which can be coupled together to form length as per the length of the tube to be cleaned. Water flow through the hollow tube and washes out deposits that are dislodged by the cleaning tools attached to the driven shafts. Typical cleaning tools used are carbide drills for severely clogged tubes, brushes for light deposits and buffing tools for final polishing of tubes. The water flow is independently controlled allowing the user to determine how much water is needed in the application.

Model C-10 is typically used on oil coolers, small heat exchanger and condensers.





Model CP-315 is typically used on larger diameter tubes of process vessels, heat exchanger and condensers.

Note - The tube cleaners above are supplied with a heavy duty plastic case with separate provision to house up to 4ft (1.2m) long hollow shafts, 15 ft (4.6m) air hose, 15ft (4.6m) water hose.

Hollow Drive Shaft - 4.2ft (1.2m) long aircraft quality steel shafts to connect to drive.

Hollow Driven Shaft - 4.2ft (1.2m) long aircraft quality steel shafts to connect to driven shafts. Order quantities based on length of tubes to be cleaned.

TUBE ID		MODEL	MOTOR POWER		SPEED RPM	AIR SUPPLY		WATER SUPPLY		WEIGHT	
MM	INCH		HP	kW		MIN	MAX	MIN	MAX	lbs	kg.
4.8 - 25.4	3/16 - 1	C-10	0.60	0.45	700	60psi @ 16cfm	90psi @ 16psi	30psi	100psi	5.72	2.6
22.2 - 51.0	7/8 - 2	C-20	1	0.745	1000	90psi @ 20cfm	90psi @ 40psi	30psi	100psi	6.50	3.0

TUBE ID		MODEL	HOLLOW DRIVE SHAFT MODEL	HOLLOW DRIVEN SHAFT MODEL	DRIVE COUPLING MODEL	SHAFT COUPLING MODEL	STARTER DRILL MODEL
MM	INCH						
			To connect to Drive 4ft (1.2 mtr.)	To connect to Driven Shaft 4ft (1.2 mtr.)	To couple Hollow Drive Shaft to Drive	To couple two hollow shaft together	To make pilot hole in deposit of completely clogged tubes
4.8 - 6.4	3/16 - 1/4	C-10	DS - 300	DN - 300	DC - 300	SC-300	--
9.5	3/8		DS - 312	DN - 312	DC - 312	SC-312	SD - 312
11.1	7/16		DS - 375	DN - 375	DC - 375	SC-375	SD - 375
12.7 - 14.3	1/2 - 9/16		DS - 437	DN - 437	DC - 437	SC-437	SD - 437
15.9 - 17.5	5/8 - 11/16		DS - 500	DN - 500	DC - 500	SC-500	SD - 500
19.1 - 20.6	3/4 - 13/16	C -20	DS - 562	DN - 562	DC - 562	SC-562	SD - 562
22.2 - 25.4	7/8 - 1		DS - 625	DN - 625	DC - 625	SC-625	SD - 625
27.0 - 51.0	1.1/16 - 2		DS - 750	DN - 750	DC - 750	SC-750	SD - 750

TUBE CLEANING BRUSHES



NYLON



STAINLESS STEEL



BRASS BRUSH

NYLON BRUSHES - Used for removing soft scales in the ferrous (carbon & stainless steel) and non-ferrous (copper, brass, plastic etc) tubes and for final finishing of tubes.

STAINLESS STEEL BRUSHES - Used for removing soft and light scale deposits in the ferrous (carbon & stainless steel) tubes.

BRASS BRUSHES - Used for removing soft and light scales deposits in straight, non-ferrous (copper, brass, nickel and their alloyed) tubes.

BRUSH O.D

	MM	INCH
FROM	6.4	1/4
UPTO	25.4	1

CUTTER HEADS & BUFFING TOOLS



CARBIDE DRILL

Carbide Drills - Used for cleaning tubes choked solidly with hard deposits.

TUBE I.D.

	MM	INCH	MM	INCH
FROM	6.4	1/4	UPTO	17.5 11/16



BUFFING TOOL



REPLACEMENT BLADES



BUFFING TOOL WITH DRILL TIP

BUFFING TOOLS - Used for final polishing or removal of light and soft deposits from ferrous and non-ferrous tubes that have been previously cleaned. Used in straight or very large radius tubes in a clockwise direction only.

TUBE I.D.

	MM	INCH	MM	INCH
FROM	7.9-9.5	5/16-3/8	UPTO	15.9-25.4 5/8-1